

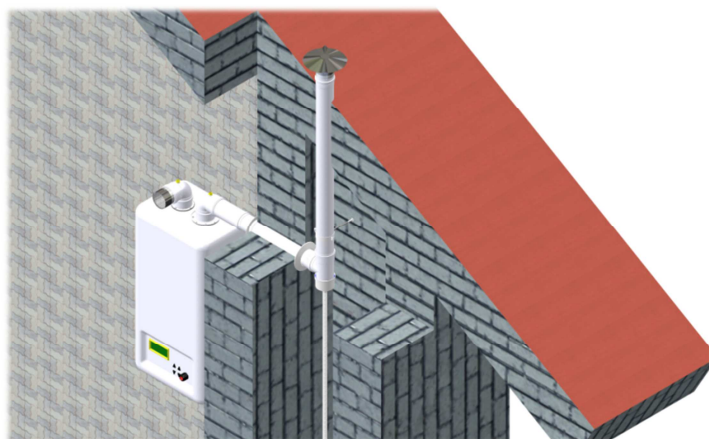

∅	60	Tubi e Curve <i>Pipes and Bends</i>	Pag.	15
∅	60	Accessori <i>Accessories</i>		16
∅	80	Tubi e Curve Linea TOP <i>Pipes and Bends Top Line</i>		18
∅	80	Tubi e Curve Linea EURO <i>Pipes and Bends Euro Line</i>		20
∅	80	Accessori <i>Accessories</i>		21
∅	80	Riduzioni <i>Adapters</i>		24
∅	80	Sdoppiatori <i>Connections</i>		25
∅	80	Raccordi di Partenza <i>Starting Adapter</i>		27
∅	80	Raccordi per Caldaie Esterne <i>Starting Adapter for External Boilers</i>		29
∅	80	Kit Sdoppiati <i>Splitter Kit</i>		30
∅	80	Linea Intubamento <i>Intubation Line</i>		35
∅	100	Tubi, Curve ed Accessori <i>Pipes, Bends and Accessories</i>		36

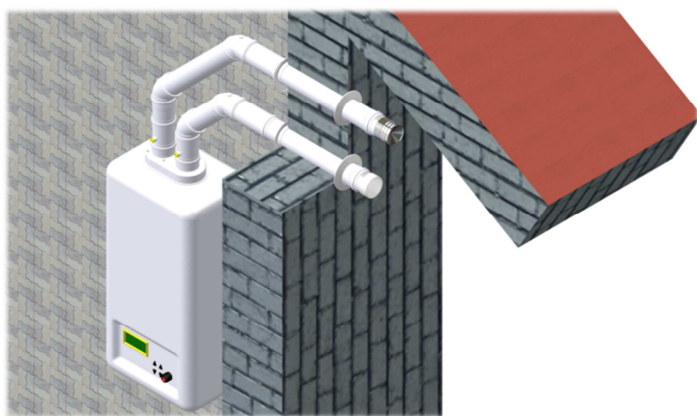

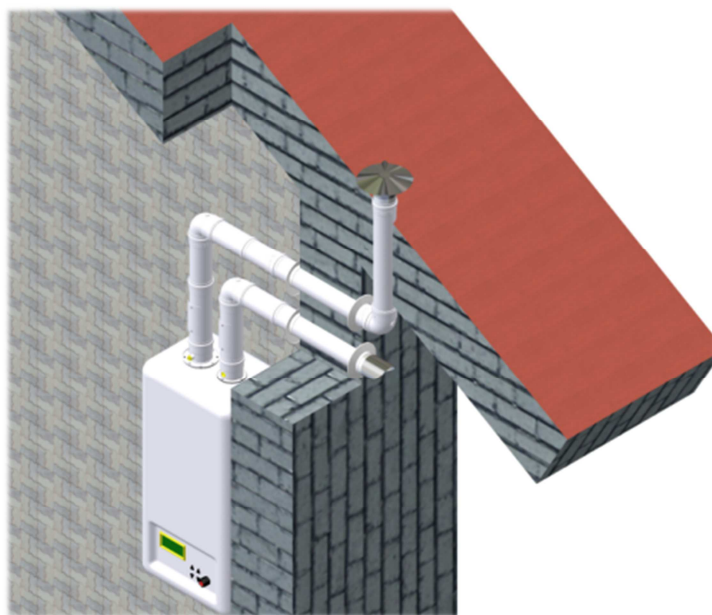
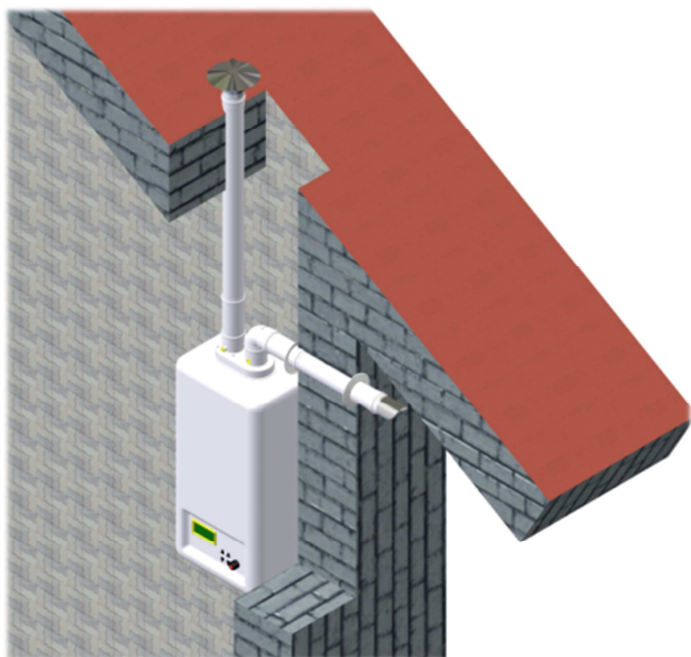

GARAZIA PRODOTTI - PRODUCTS WARRANTY

Tutti i nostri prodotti sono coperti da garanzia come da Decreto Legislativo N. 24 del 2 Febbraio 2002 in attuazione alla direttiva 1999/44/CE.
All our products are covered by warranty in Legislative Decree No.24 of 24 February 2002 pursuant to Directive 199/44/CE.

N B:

Tutti gli accessori di nostra produzione, specifici e compatibili per le caldaie a camera stagna di classe C fino a KW 35, sono componenti d'impianto idonei per lo scarico e l'aspirazione aria a tiraggio forzato, previa verifica ed approvazione da parte della ditta installatrice come richiesto dalla legge 49/90.

Al fine di migliorare la qualità, la CONTI S.r.l. si riserva la prerogativa di variare in qualsiasi momento e senza alcun preavviso le caratteristiche dei prodotti.

All the accessories of our production, specific and compatible to the sealed chamber boilers Class C up to 35kw, plant components are suitable for the discharge and suction air forced draft, subject to verification and approval by the installation company as required by law 49/90.

In order to improve the quality, CONTI Srl reserves the prerogative to change at any time and without prior notice, the characteristics of the products.

TUBO in Alluminio Estruso in Lega *Extruded Aluminum PIPE* **EN AW-6060**

Completo di guarnizione a triplo labbro in Silicone *With triple lip silicon seal*

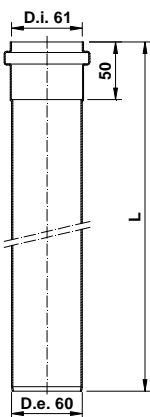

M/F 10/10

TA026MFB
TA061MFB
TA065MFB
TA062MFB

2000 mm
 1000 mm
 500 mm
 250 mm

Bianco *White*
 RAL 9016

15,86
 10,30
 7,67
 5,72

2
 9
 10
 2

M/F 10/10

TA026MFN
TA061MFN
TA065MFN
TA062MFN

2000 mm
 1000 mm
 500 mm
 250 mm

Alluminio Naturale
Natural Aluminum

13,85
 9,04
 6,87
 5,15

2
 9
 10
 2

M/F 15/10

TA161MFB
TA165MFB
TA162MFB

1000 mm
 500 mm
 250 mm

Bianco *White*
 RAL 9016

12,14
 8,93
 6,64

9
 10
 2

Bicchieratura Calibrata
Calibrated Female Side Diameter

CURVA 90° in Alluminio Pressofuso in Lega *90° Die-casted Aluminum BEND Alloy* **EN AB-46100**

Completo di guarnizione a triplo labbro in Silicone *With triple lip silicon seal*

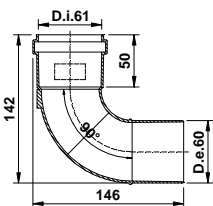

M/F 20/10
 R 60 mm

CAP9006B

Bianco *White*
 RAL 9016

10,71

6

CAP9006N

Alluminio Naturale
Natural Aluminum

10,25

6

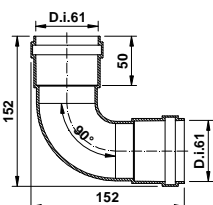

F/F 20/10
 R 48 mm

CAPF906B

Bianco *White*
 RAL 9016

13,22

4

CAPF906N

Alluminio Naturale
Natural Aluminum

12,76

4

CURVA 45° in Alluminio Pressofuso *45° Die-casted Aluminum BEND*

Completo di guarnizione a triplo labbro in Silicone *With triple lip silicon seal*

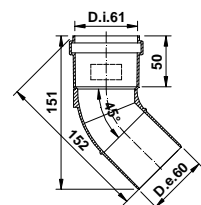

M/F 20/10
 R 60 mm

CAP4506B

Bianco *White*
 RAL 9016

10,07

6

CAP4506N

Alluminio Naturale
Natural Aluminum

9,61

6

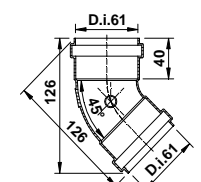

F/F 20/10
 R 50 mm

CAPF456B

Bianco *White*
 RAL 9016

12,59

6

CAPF456N

Alluminio Naturale
Natural Aluminum

12,14

6

TEE in Alluminio Estruso/saldato in Lega *Extruded/welded Aluminum TEE Alloy* **EN AW-6060**

Completo di guarnizione a triplo labbro in Silicone *With triple lip silicon seal*

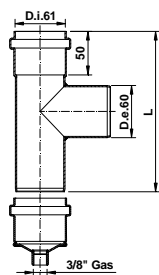

M/M/F 15/10

TEIMM6V

185 mm

Bianco *White*
RAL 9016

11,79

3

TEIMM6N

Alluminio Naturale
Natural Aluminum

11,10

3

M/M/F 15/10

Completo di tappo scarico
condensa
With condensation drain plug

TEISCM6V

210 mm

Bianco *White*
RAL 9016

18,89

3

TEISCM6N

Alluminio Naturale
Natural Aluminum

17,86

3

Bicchieratura Calibrata
Calibrated Female Side Diameter

TUBO in Alluminio Estruso con portello ispezione orizzontale / verticale In Lega

Extruded Aluminum PIPE with horizontal / vertical inspection door Alloy **EN AW-6060**

Completo di guarnizione a triplo labbro in Silicone e viti *With triple lip silicon seal and screws*

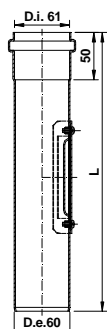

M/F 15/10

TCSI060B

295 mm

Bianco *White*
RAL 9016

13,00

1

TCSI060N

295 mm

Alluminio Naturale
Natural Aluminum

12,50

1

Bicchieratura Calibrata
Calibrated Female Side Diameter

MANICOTTO in Alluminio Estruso in Lega *Extruded Aluminum SLEEVE Alloy* **EN AW-6060**

Completo di guarnizione a triplo labbro in Silicone *With triple lip silicon seal*

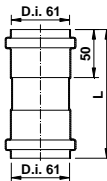

F/F 10/10

MFF6060B

130 mm

Bianco *White*
RAL 9016

7,04

3

MFF6060N

130 mm

Alluminio Naturale
Natural Aluminum

6,64

3

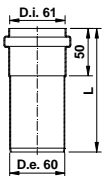

M/F 10/10

MMF6060B

130 mm

Bianco *White*
RAL 9016

5,44

3

MMF6060N

130 mm

Alluminio Naturale
Natural Aluminum

5,04

3

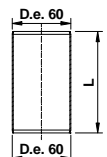

M/M 10/10

MMM6060N

100 mm

Alluminio Naturale
Natural Aluminum

3,60

3

Bicchieratura Calibrata
Calibrated Female Side Diameter

MANICOTTO in Alluminio Estruso con raccolta scarico condensa in Lega

Extruded Aluminum SLEEVE with collector condensation drain Alloy **EN AW-6060**

Completo di guarnizione a triplo labbro in Silicone *With triple lip silicon seal*

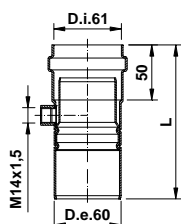

M/F 15/10

TSC6014B

140 mm

Bianco *White*
RAL 9016

16,50

3

TSC6014N

140 mm

Alluminio Naturale
Natural Aluminum

15,90

3

Bicchieratura Calibrata
Calibrated Female Side Diameter

TERMINALI in Acciaio Inox *Stainless steel TERMINALS*

	<p>Aspirazione aria orizzontale <i>Horizontal air inlet</i></p>	<p>TERMA06I</p>	<p>Acciaio Inox <i>Stainless steel</i> AISI 304</p>	<p>4,42</p>	<p>10</p>
	<p>Scarico fumi orizzontale <i>Horizontal flue outlet</i></p>	<p>TERM06I</p>	<p>Acciaio Inox <i>Stainless steel</i> AISI 304</p>	<p>5,38</p>	<p>10</p>
	<p>Scarico fumi verticale <i>Vertical flue outlet</i></p>	<p>TERM06IA</p>	<p>Acciaio Inox <i>Stainless steel</i> AISI 304</p>	<p>12,36</p>	<p>4</p>

COLLARE in Acciaio *Steel WALL BRACKET*

	<p>Lunghezza gambo <i>Anchor length</i> 200mm</p>	<p>COFERB06</p>	<p>Bianco <i>White</i> RAL 9016</p>	<p>2,81</p>	<p>10</p>
--	---	------------------------	--	-------------	-----------

ROSONE coprimuro in EPDM *EPDM wall COVER*

		<p>RCEP06</p>	<p>Bianco <i>White</i></p>	<p>2,12</p>	<p>20</p>
--	--	----------------------	---------------------------------	-------------	-----------

GUARNIZIONE in SILICONE *SILICON SEAL*

	<p>A triplo labbro <i>Triple Lip</i></p>	<p>ORL06S</p>	<p>Azzurro <i>Blue</i></p>	<p>1,03</p>	<p>10</p>
	<p>A corda <i>Cord</i></p>	<p>OR06S</p>	<p>Rossa <i>Red</i></p>	<p>0,52</p>	<p>10</p>

TUBO in Alluminio Estruso in Lega *Extruded Aluminum PIPE Alloy* **EN AW-6060**

Completo di guarnizione a triplo labbro in Silicone *With triple lip silicon seal*

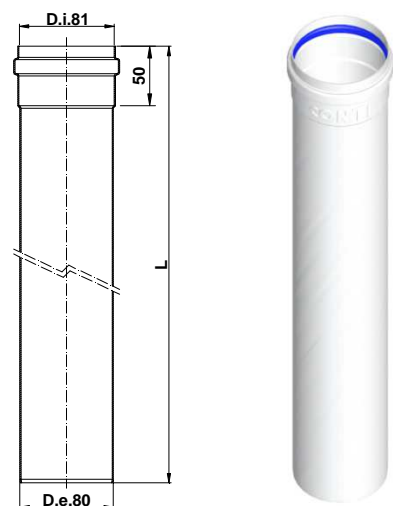

DESCRIZIONE DESCRIPTION	CODICE CODE	LUNGHEZZA LENGTH	COLORE COLOUR	€/Pz €/Pcs	Pz/Conf. Pcs/Box
M/F 10/10	TAL38MFB	2700 mm	Bianco White RAL 9016	32,67	8
	TAL28MFB	2000 mm		22,55	10
	TAL15MFB	1500 mm		17,92	10
	TAL81MFB	1000 mm		11,25	10
	TAL85MFB	500 mm		7,80	9
	TAL82MFB	250 mm		5,60	12
M/F 10/10	TAL28MFA *	2000 mm	Avorio Opaco Opaque Ivory	23,03	10
	TAL81MFA *	1000 mm		11,49	10
	TAL85MFA *	500 mm		7,97	9
	TAL82MFA *	250 mm		5,72	12
M/F 10/10	TAL38MFN	2700 mm	Alluminio Naturale Natural Aluminum	29,53	8
	TAL28MFN	2000 mm		20,00	10
	TAL15MFN	1500 mm		16,36	10
	TAL81MFN	1000 mm		10,07	10
	TAL85MFN	500 mm		7,04	9
	TAL82MFN	250 mm		5,06	12
M/F 15/10	TA938MFB	2700 mm	Bianco White RAL 9016	38,68	8
	TA928MFB	2000 mm		28,67	10
	TA915MFB	1500 mm		21,53	10
	TA981MFB	1000 mm		14,69	10
	TA985MFB	500 mm		8,93	9
	TA982MFB	250 mm		6,89	12
M/F 15/10	TA938MFN	2700 mm	Alluminio Naturale Natural Aluminum	34,06	8
	TA928MFN	2000 mm		26,79	10
	TA915MFN	1500 mm		19,97	10
	TA981MFN	1000 mm		13,51	10
	TA985MFN	500 mm		8,18	9
	TA982MFN	250 mm		6,35	12

Bicchieratura Calibrata
 Calibrated Female Side Diameter

TUBO in Alluminio Estruso in Lega *Extruded Aluminum PIPE Alloy* **EN AW-6060**

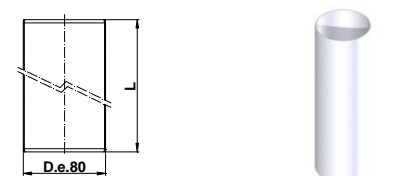

DESCRIZIONE DESCRIPTION	CODICE CODE	LUNGHEZZA LENGTH	COLORE COLOUR	€/Pz €/Pcs	Pz/Conf. Pcs/Box
M/M 10/10 Rastremato alle estremità Tapered at both sides	TA801MMB	1000 mm	Bianco White RAL 9016	10,56	6
	TA805MMB	500 mm		7,21	6
	TA802MMB	250 mm		5,10	4

MANICOTTO TELESCOPICO in Alluminio Estruso in Lega *Extruded Aluminum TELESCOPIC SLEEVE Alloy* **EN AW-6060**

Completo di guarnizione a triplo labbro in Silicone *With triple lip silicon seal*

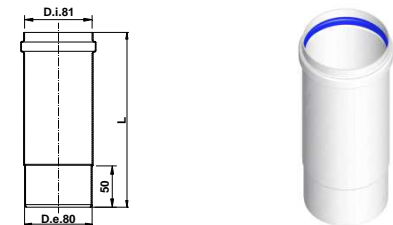

DESCRIZIONE DESCRIPTION	CODICE CODE	LUNGHEZZA LENGTH	COLORE COLOUR	€/Pz €/Pcs	Pz/Conf. Pcs/Box
M/F 10/10	MSMF821V	210 mm	Bianco White RAL 9016	8,68	4
	MSMF821A *	210 mm	Avorio Opaco Opaque Ivory	8,87	4
	MSMF821N	210 mm	Alluminio Naturale Natural Aluminum	8,38	4

Bicchieratura Calibrata
 Calibrated Female Side Diameter

TUBO ANTICONDENSA in Alluminio Estruso in Lega *Extruded Aluminum ANTICONDENSATION PIPE Alloy* **EN AW-6060**

Completo di guarnizione a triplo labbro in Silicone *With triple lip silicon seal*

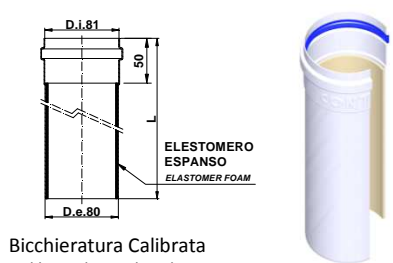

DESCRIZIONE DESCRIPTION	CODICE CODE	LUNGHEZZA LENGTH	COLORE COLOUR	€/Pz €/Pcs	Pz/Conf. Pcs/Box
M/F 10/10 Solo per aspirazione aria comburente Only for air intake comburent - assorbimento acqua vol. %0.8 - temperatura di utilizzo -80/+100 °c - densità Kg/mc. 35 - conduttività termica Kcal./m.h °c 20/0,035 - water absorption vol. %0.8 - temperature of use -80/+100 °c - density Kg/mc. 35 - thermal conductivity Kcal./m.h °c 20/0,035	TAA81MFB	1000 mm	Bianco White RAL 9016	17,11	10
	TAA85MFB	500 mm		11,80	9
	TAA81MFA *	1000 mm	Avorio Opaco Opaque Ivory	17,87	10
	TAA85MFA *	500 mm		12,32	9

Bicchieratura Calibrata
 Calibrated Female Side Diameter

CURVA 90° in Alluminio Pressofuso in Lega 90° Die-casted Aluminum BEND Alloy EN AB-46100

Completo di guarnizione a triplo labbro in Silicone With triple lip silicon seal

		M/F 20/10 R 40 mm	CAP9008B	Bianco White RAL 9016	8,15	20
			CAP9008A *	Avorio Opaco Opaque Ivory	8,41	20
			CAP9008N	Alluminio Naturale Natural Aluminum	7,84	20
		M/F 20/10 Con ispezione With inspection R 40 mm	CAP908B	Bianco White RAL 9016	10,06	4
			CAP908A *	Avorio Opaco Opaque Ivory	10,39	4
			CAP908N	Alluminio Naturale Natural Aluminum	9,90	4
		F/F 20/10 R 40 mm	CAPF908B	Bianco White RAL 9016	10,06	12
			CAPF908A *	Avorio Opaco Opaque Ivory	10,39	12
			CAPF908N	Alluminio Naturale Natural Aluminum	9,90	12

CURVA 45° in Alluminio Pressofuso in Lega 45° Die-casted Aluminum BEND Alloy EN AB-46100

Completo di guarnizione a triplo labbro in Silicone With triple lip silicon seal

		M/F 20/10 R 40 mm	CAP4508B	Bianco White RAL 9016	8,15	15
			CAP4508A *	Avorio Opaco Opaque Ivory	8,41	15
			CAP4508N	Alluminio Naturale Natural Aluminum	7,84	15
		F/F 20/10 R 40 mm	CAPF458B	Bianco White RAL 9016	10,06	15
			CAPF458A *	Avorio Opaco Opaque Ivory	10,39	15
			CAPF458N	Alluminio Naturale Natural Aluminum	9,90	15

CURVA 90° in Alluminio Pressofuso in Lega 90° Die-casted Aluminum BEND Alloy EN AB-46100

Completo di guarnizione a triplo labbro in Silicone With triple lip silicon seal

		M/F 20/10 R 60 mm Largo raggio Large radius	CAP9086B	Bianco White RAL 9016	10,67	12
			CAP9086A *	Avorio Opaco Opaque Ivory	11,11	12
			CAP9086N	Alluminio Naturale Natural Aluminum	10,21	12
		M/F 20/10 Con ispezione With inspection R 60 mm Largo raggio Large radius	CAP986B	Bianco White RAL 9016	12,64	4
			CAP986A *	Avorio Opaco Opaque Ivory	13,17	4
			CAP986N	Alluminio Naturale Natural Aluminum	12,20	4
		F/F 20/10 R 60 mm Largo raggio Large radius	CAPF986B	Bianco White RAL 9016	12,14	12
			CAPF986A *	Avorio Opaco Opaque Ivory	12,65	12
			CAPF986N	Alluminio Naturale Natural Aluminum	11,70	12

TUBO in Alluminio Estruso in Lega *Extruded Aluminum pipe Alloy* **EN AW-6060**

Completo di guarnizione a triplo labbro in Silicone *With triple lip silicon seal*

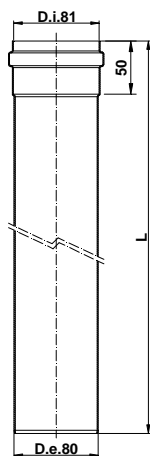

M/F 10/10

EUR38MFB	2700 mm	Bianco <i>White</i> RAL 9016	29,71	8
EUR28MFB	2000 mm		20,09	10
EUR15MFB	1500 mm		15,97	10
EUR81MFB	1000 mm		10,00	10
EUR85MFB	500 mm		7,11	9
EUR82MFB	250 mm		5,05	12

M/F 10/10

EUR38MFN	2700 mm	Alluminio Naturale <i>Natural Aluminum</i>	26,64	8
EUR28MFN	2000 mm		18,69	10
EUR15MFN	1500 mm		14,79	10
EUR81MFN	1000 mm		9,06	10
EUR85MFN	500 mm		6,37	9
EUR82MFN	250 mm		4,53	12

M/F 15/10

EU938MFB	2700 mm	Bianco <i>White</i> RAL 9016	36,81	8
EU928MFB	2000 mm		27,28	10
EU915MFB	1500 mm		20,49	10
EU981MFB	1000 mm		13,99	10
EU985MFB	500 mm		8,50	9
EU982MFB	250 mm		6,57	12

M/F 15/10

EU938MFN	2700 mm	Alluminio Naturale <i>Natural Aluminum</i>	33,68	8
EU928MFN	2000 mm		25,40	10
EU915MFN	1500 mm		18,94	10
EU981MFN	1000 mm		12,80	10
EU985MFN	500 mm		7,75	9
EU982MFN	250 mm		6,03	12

Bicchieratura Calibrata
Calibrated Female Side Diameter

CURVA 90° in Alluminio Pressofuso in Lega *90° Die-casted Aluminum BEND Alloy* **EN AB-46100**

Completo di guarnizione a triplo labbro in Silicone *With triple lip silicon seal*

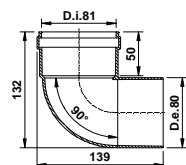

M/F
 R 40 mm

EUR9008B	Bianco <i>White</i> RAL 9016	6,57	20
EUR9008N		Alluminio Naturale <i>Natural Aluminum</i>	6,11

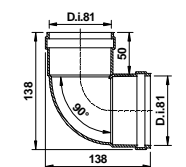

F/F
 R 40 mm

EURF908B	Bianco <i>White</i> RAL 9016	8,07	12
EURF908N		Alluminio Naturale <i>Natural Aluminum</i>	7,61

CURVA 45° in Alluminio Pressofuso in Lega *45° Die-casted Aluminum BEND Alloy* **EN AB-46100**

Completo di guarnizione a triplo labbro in Silicone *With triple lip silicon seal*

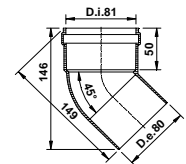

M/F
 R 40 mm

EUR4508B	Bianco <i>White</i> RAL 9016	6,57	15
EUR4508N		Alluminio Naturale <i>Natural Aluminum</i>	6,11

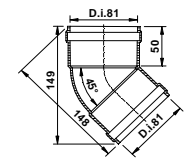

F/F
 R 40 mm

EURF458B	Bianco <i>White</i> RAL 9016	8,55	15
EURF458N		Alluminio Naturale <i>Natural Aluminum</i>	8,14

CURVA 90° in Alluminio Pressofuso in Lega *90° Die-casted Aluminum BEND Alloy* **EN AB-46100**

Completo di guarnizione a triplo labbro in Silicone *With triple lip silicon seal*

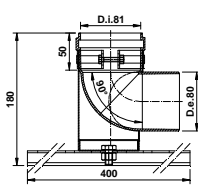

M/F
 Con staffa di sostegno
With support bracket
 R 40 mm

EURST9008N	Alluminio Naturale <i>Natural Aluminum</i>	25,19	4
-------------------	---	-------	---

MANICOTTO in Alluminio Estruso in Lega Extruded Aluminum SLEEVE Alloy EN AW-6060

Completo di guarnizione a triplo labbro in Silicone *With triple lip silicon seal*

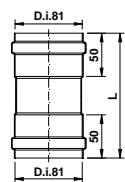

F/F 10/10

MFF0808V

147 mm

Bianco *White*
 RAL 9016

8,93

5

MFF0808A *

147 mm

Avorio Opaco
Opaque Ivory

9,11

5

MFF0808N

147 mm

Alluminio Naturale
Natural Aluminum

8,47

5

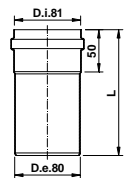

M/F 10/10

MMF0808V

150 mm

Bianco *White*
 RAL 9016

6,64

5

MMF0808N

150 mm

Alluminio Naturale
Natural Aluminum

6,18

5

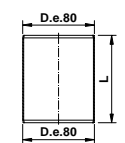

M/M 10/10

MMM0808N

100 mm

Alluminio Naturale
Natural Aluminum

2,92

5

Bicchieratura Calibrata

Calibrated Female Side Diameter

MANICOTTO in Alluminio Estruso con raccolta scarico condensa in Lega Extruded Aluminum SLEEVE with collector condensation drain Alloy EN AW-6060

Completo di guarnizione a triplo labbro in Silicone *With triple lip silicon seal*

Completo di guarnizione a triplo labbro in Silicone *With triple lip silicon seal*

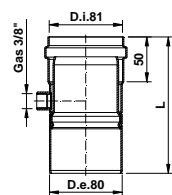

M/F 15/10

TSC8019B

152 mm

Bianco *White*
 RAL 9016

16,87

5

TSC8019N

152 mm

Alluminio Naturale
Natural Aluminum

16,41

5

Bicchieratura Calibrata

Calibrated Female Side Diameter

MANICOTTO in Alluminio Estruso in Lega con presa ispezione fumi/aria Extruded Aluminum SLEEVE with inspection air/flue outlet Alloy EN AW-6060

Completo di guarnizione a triplo labbro in Silicone *With triple lip silicon seal*

Completo di guarnizione a triplo labbro in Silicone *With triple lip silicon seal*

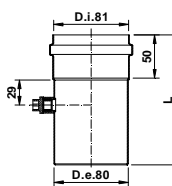

M/F 15/10

TFA8012B

150 mm

Bianco *White*
 RAL 9016

10,16

5

TFA8012N

150 mm

Alluminio Naturale
Natural Aluminum

9,70

5

Bicchieratura Calibrata

Calibrated Female Side Diameter

TUBO in Alluminio Estruso con portello ispezione orizzontale/verticale in Lega Extruded Aluminum PIPE with horizontal/vertical inspection door Alloy EN AW-6060

Completo di guarnizione a triplo labbro in Silicone e viti *With triple lip silicon seal and screws*

Completo di guarnizione a triplo labbro in Silicone e viti *With triple lip silicon seal and screws*

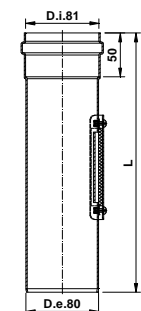

M/F 15/10

TCSI080B

295 mm

Bianco *White*
 RAL 9016

13,11

1

TCSI080N

295 mm

Alluminio Naturale
Natural Aluminum

12,51

1

Bicchieratura Calibrata

Calibrated Female Side Diameter

TEE in Alluminio Pressofuso in Lega Die-Casted Aluminum TEE Alloy EN AB-46100

Completo di guarnizione a triplo labbro in Silicone *With triple lip silicon seal*

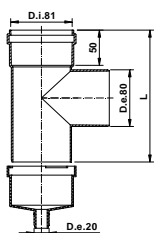

M/M/F 20/10
 Completo di tappo scarico
 condensa in PA Bianco
*With condensation drain plug
 in White PA*

TEISCM8V

220 mm

Bianco *White*
 RAL 9016

22,40

6

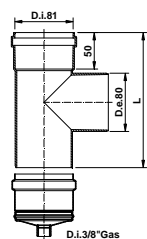

M/M/F 20/10
 Completo di tappo scarico
 condensa in Alluminio
*With Aluminum condensation
 drain plug thickness
 15/10*

TEISCM8N

220 mm

Alluminio Naturale
Natural Aluminum

21,40

6

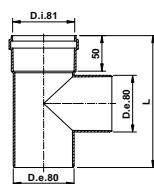

M/M/F 20/10
 Senza tappo scarico
 condensa
*Without condensation drain
 plug*

TEIMM8V

186 mm

Bianco *White*
 RAL 9016

15,00

6

TEIMM8A *

186 mm

Avorio Opaco
Opaque Ivory

15,45

6

TEIMM8N

186 mm

Alluminio Naturale
Natural Aluminum

14,30

6

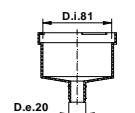

Tappo scarico condensa in
 PA
*PA condensation drain plug
 20/10*

TISSC08V

9,00

6

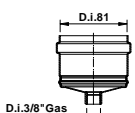

Tappo scarico condensa in
 Alluminio
*Aluminum condensation drain
 plug 15/10*

TISSC08N

8,70

6

Bicchieratura Calibrata
Calibrated Female Side Diameter

TERMINALE scarico fumi in Acciaio Inox Stainless steel flue outlet TERMINAL

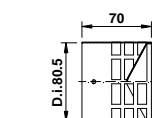

Orizzontale
Horizontal

TERM08I

Acciaio Inox
*Stainless steel
 AISI 304*

5,55

10

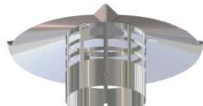
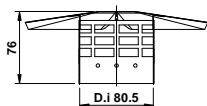

Verticale
Vertical

TERM08IA

Acciaio Inox
*Stainless steel
 AISI 304*

12,42

12

TERMINALE aspirazione aria Air inlet TERMINAL

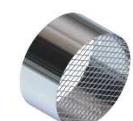
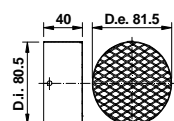

Orizzontale
Horizontal

TERMA08I

Acciaio Inox
*Stainless steel
 AISI 304*

4,42

20

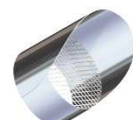
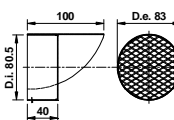

Orizzontale con cappello
 parapiovanna
Horizontal with rain cap

TERMA08IPG

Acciaio Inox
*Stainless steel
 AISI 304*

6,60

8

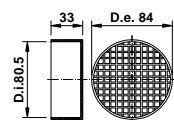

Orizzontale
Horizontal

TERM08P

Polipropilene Bianco
Polypropylene White

2,06

20

MANICOTTO in silicone rosso con fascetta metallica *Red silicon SLEEVE with Metal clamp*

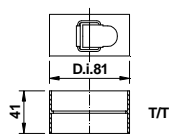

FMPV08SV

Bianco *White*
 RAL 9016

6,30

6

FMPV08SN

Alluminio Naturale
Natural Aluminum

5,84

6

COLLARE in Acciaio *Steel WALL BRACKET*

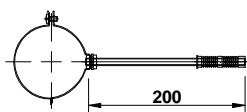

Lunghezza gambo
Anchor length
 200 mm

COFERB

Bianco *White*
 RAL 9016

3,15

25

COFERBA *

Avorio Opaco
Opaque Ivory

3,84

10

COFERN

Alluminio Naturale
Natural Aluminum

2,86

25

TUBO di Centraggio Inox *Steel Centering PIPE*

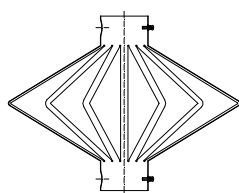

TUBCENTR80

500 mm

Acciaio Inox
Stainless steel
 AISI 304

25,00

1

ROSONE coprimuro in EPDM *EPDM wall COVER*

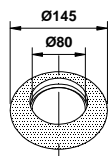

RCEP08

Bianco
White

2,34

20

GUARNIZIONE in SILICONE *SILICON SEAL*

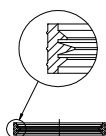

A triplo labbro
Triple lip

ORL08S

Azzurro
Blue

1,09

10



A corda
Cord

OR08S

Rossa
Red

0,57

10

RIDUZIONE in Alluminio Estruso in Lega *Extruded Aluminum ADAPTER Alloy* **EN AW-6060**

Completo di guarnizione a triplo labbro in Silicone *With triple lip silicon seal*

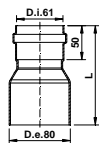

Ø80/60 M/F 15/10

MFM0608B

135 mm

Bianco *White*
 RAL 9016

9,64

6

MFM0608N

135 mm

Alluminio Naturale
Natural Aluminum

9,22

6

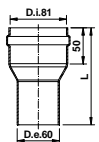

Ø80/60 F/M 15/10

MMF0608B

131 mm

Bianco *White*
 RAL 9016

10,15

8

MMF0608N

131 mm

Alluminio Naturale
Natural Aluminum

9,80

8

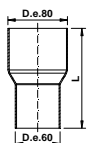

Ø80/60 M/M 15/10

MMM0608B

137 mm

Bianco *White*
 RAL 9016

7,86

6

MMM0608N

137 mm

Alluminio Naturale
Natural Aluminum

7,42

6

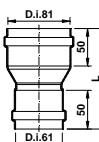

Ø80/60 F/F 15/10

MFF0608B

130 mm

Bianco *White*
 RAL 9016

10,40

8

MFF0608N

130 mm

Alluminio Naturale
Natural Aluminum

9,98

8

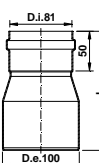

Ø100/80 M/F 12/10

MMF0801V

150 mm

Bianco *White*
 RAL 9016

11,10

4

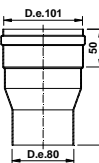

Ø100/80 F/M 12/10

MFM0108V

148 mm

Bianco *White*
 RAL 9016

11,34

4

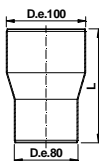

Ø100/80 M/M 12/10

MMM0801V

132 mm

Bianco *White*
 RAL 9016

8,20

4

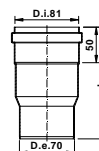

Ø80/70 F/M 15/10

MMF0708B

155 mm

Bianco *White*
 RAL 9016

10,88

5

Bicchieratura Calibrata
Calibrated Female Side Diameter

RIDUZIONE in Alluminio *Aluminum ADAPTER*

Completo di guarnizione a triplo labbro in Silicone *With triple lip silicon seal*

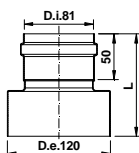

Ø120/80 M/F 15/10

MFM0812B

113 mm

Bianco *White*
 RAL 9016

11,80

4

Bicchieratura Calibrata
Calibrated Female Side Diameter

N.B. quote in mm

SDOPPIATORE monoblocco con attacchi in All. Estruso in Lega CONNECTION with Extruded Alu. fastening Alloy EN AW-6060

Completo di guarnizioni a triplo labbro in Silicone, di tappi ispezione aria/fumi (ove dovuto), di guarnizioni per flange e viti di fissaggio.

With triple lip silicon seal, inspection flue/air plugs (where due), seals for flange and screws.

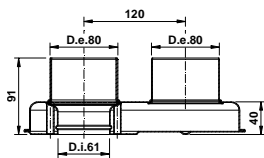

Compatibile *Suitable for:*

- ARCA
- ARGO
- BALTUR
- BAXI
- BERETTA
- BIASI
- BONGIOANNI
- EUROTHERM
- FINTERM
- FONDITAL
- HERMANN
- LAMBORGHINI
- PENSOTTI
- PROTHERM
- RHOSS
- RIELLO
- RINNAI
- ROCA
- SANT'ANDREA
- SARIGAS
- SILE
- SIME
- SYLBER
- UNICAL
- VISSMANN

S0808MMB

Bianco *White*
 RAL 9016

18,84

6

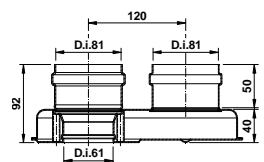

S0808FFB

Bianco *White*
 RAL 9016

20,10

6

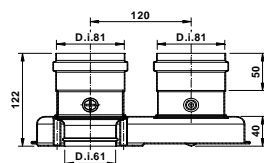

Con attacco flangia Ø128
With Ø128 fastening flange

S08PIFFB

Bianco *White*
 RAL 9016

24,36

4

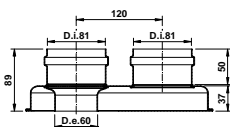

Compatibile *Suitable for:*
VAILLANT

S08VMFFB

Bianco *White*
 RAL 9016

18,60

1

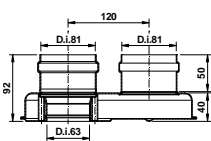

F/F
 Con attacco Ø63
 flangia Ø128
*With fastening Ø63
 flange Ø128*

S0863FFB

Bianco *White*
 RAL 9016

19,56

1

SDOPPIATORE monoblocco con attacchi in All. Estruso in Lega CONNECTION with Extruded Alu. fastening Alloy EN AW-6060

Completo di guarnizioni a triplo labbro in Silicone, di tappi ispezione aria/fumi (ove dovuto), di guarnizioni per flange e viti di fissaggio.

With triple lip silicon seal, inspection flue/air plugs (where due), seals for flange and screws.

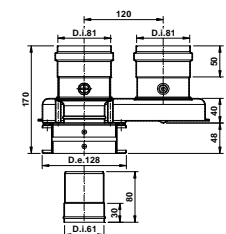

Compatibile *Suitable for:*
SAVIO
 Con attacco flangia Ø128
 With Ø128 fastening flange

S08SAFFB

Bianco *White*
 RAL 9016

33,24

1

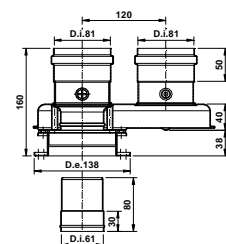

Compatibile *Suitable for:*
**SAUNIER DUVAL /
 HERMANN**
 Con attacco flangia Ø138
 With Ø138 fastening flange

S08FFFB

Bianco *White*
 RAL 9016

28,10

1

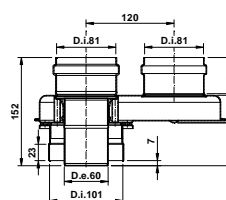

Compatibile *Suitable for:*
**ARISTON
 CHAFFOTEAUX
 ECOFLAM
 RHEEM RADI
 SIMAT**

S08FFMFB

Bianco *White*
 RAL 9016

22,90

1

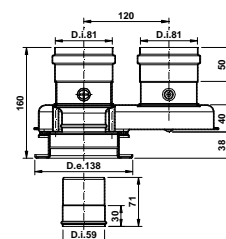

Compatibile *Suitable for:*
JUNKERS BOSCH
 Con attacco flangia Ø138
 With Ø138 fastening flange

S08SCFFB

Bianco *White*
 RAL 9016

27,85

1

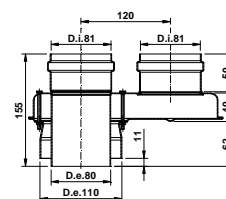

Compatibile *Suitable for:*
JUNKERS BOSCH

S0811FFB

Bianco *White*
 RAL 9016

23,28

1

Bicchieratura Calibrata
 Calibrated Female Side Diameter

RACCORDO di PARTENZA in Alluminio Estruso in Lega *Extruded Aluminum STARTING ADAPTER Alloy* **EN AW-6060**

Completo di guarnizioni a triplo labbro in Silicone, di guarnizioni per flange e viti di fissaggio *With triple lip silicon seal, seals for flange and screws*

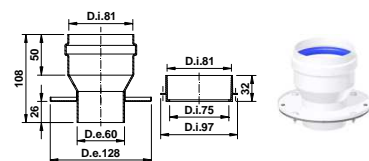

Compatibile *Suitable for:*
**FER
 FERROLI**
 Con attacco flangia Ø128
With Ø128 fastening flange

S0610FERB

Bianco *White*
 RAL 9016

16,80

1

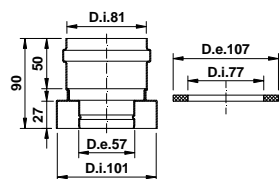

Compatibile *Suitable for:*
**ARISTON
 CHAFFOTEAUX
 ECOFLAM
 SIMAT**

S061008B

Bianco *White*
 RAL 9016

16,20

1

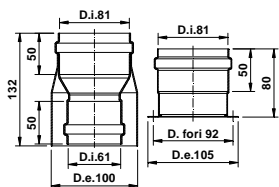

Compatibile *Suitable for:*
**ARGO
 BAXI
 ROCA**

S080806B

Bianco *White*
 RAL 9016

22,68

1

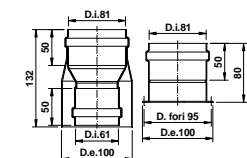

Compatibile *Suitable for:*
**BERETTA
 RIELLO
 RINNAI
 SYLBER**

S0808BR5B

Bianco *White*
 RAL 9016

22,68

1

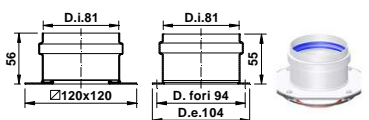

Compatibile *Suitable for:*
IMMERGAS
 Con attacco flangia Quadra
With square fastening flange
 L=120x120

S080803B

Bianco *White*
 RAL 9016

18,60

1

S080803A *

Avorio Opaco
Opaque Ivory

19,34

1

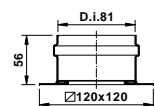

Compatibile *Suitable for:*
IMMERGAS
 Solo fumi *Only flue*
 Con attacco flangia Quadra
With square fastening flange
 L=120x120

S03BFB

Bianco *White*
 RAL 9016

12,60

1

S03BFA *

Avorio Opaco
Opaque Ivory

13,10

1

Bicchieratura Calibrata
Calibrated Female Side Diameter

N.B. quote in mm

RACCORDO di PARTENZA in Alluminio Estruso in Lega *Extruded Aluminum STARTING ADAPTER Alloy* **EN AW-6060**

Completo di guarnizioni a triplo labbro in Silicone, di tappi ispezione aria/fumi (ove dovuto), di guarnizioni per flange e viti di fissaggio.

With triple lip silicon seal, inspection flue/air plugs (where due), seals for flange and screws.

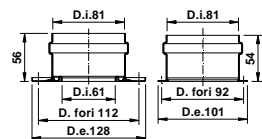

Compatibile *Suitable for:*

- ARCA
- BALTUR
- BIASI
- BONGIOANNI
- EUROTERM
- FINTERM
- FONDITAL
- HERMANN
- LAMBORGHINI
- PENSOTTI
- PROTHERM
- RHOSS
- SANT'ANDREA
- SARIGAS
- SAVIO
- SILE
- SIME

S080807B

Bianco *White*
 RAL 9016

17,22

1

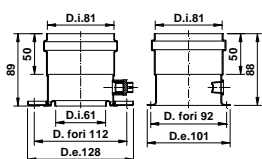

Con attacco lato fumi
 flangia Ø128
*With fastening flue side Ø128
 flange*

S08PI07B

Bianco *White*
 RAL 9016

22,10

1

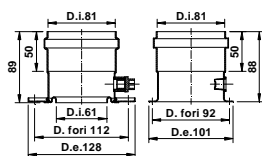

Compatibile *Suitable for:*
RADIANT
 Completo di 3 diaframmi
With 3 diaphragms
 Con attacco lato fumi
 flangia Ø128
*With fastening flue side Ø128
 flange*

S080801RB

Bianco *White*
 RAL 9016

27,60

1

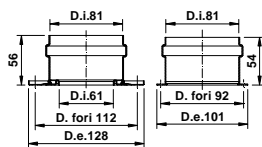

Compatibile *Suitable for:*
UNICAL
 Completo di tappo Ø108 e
 diaframma speciale
 Ø102/61
*With Ø108 plug and special
 diaphragm Ø102/61*
 Con attacco lato fumi
 flangia Ø128
*With fastening flue side Ø128
 flange*

S080809B

Bianco *White*
 RAL 9016

21,12

1

Bicchieratura Calibrata
Calibrated Female Side Diameter

FLANGIA DI RACCORDO in Alluminio *Aluminum FLANGE ADAPTER*

Completo di guarnizioni per flange e viti di fissaggio *With seals for flange and screws*

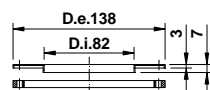

Compatibile *Suitable for:*
FERROLI

SF08FN

Naturale
Natural

5,80

5

RACCORDO di PARTENZA per scarico fumi in Alluminio *Aluminum STARTING ADAPTER for flue outlet*

Completo di guarnizioni a triplo labbro in Silicone, di guarnizione a corda, di guarnizioni per flange e viti di fissaggio *With triple lip silicon seal, cord seal, seals for flange and screws*

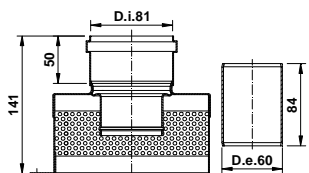

Compatibile *Suitable for:*
VAILLANT

S086014B

Bianco *White*
 RAL 9016

22,35

1

Compatibile *Suitable for:*
**ARCA
 BALTUR
 BIASI
 BONGIOANNI
 FINTERM
 FONDITAL
 HERMANN
 LAMBORGHINI
 PENSOTTI
 RADIANT
 RHOSS
 ROCA
 SANT'ANDREA
 SARIGAS
 SAVIO
 SILE
 SIME
 UNICAL**

S61008UB

Bianco *White*
 RAL 9016

20,86

1

Con attacco flangia Ø128
With Ø128 fastening flange

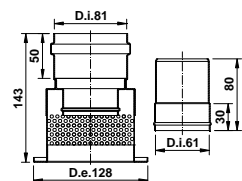

Compatibile *Suitable for:*
**SAUNIER DUVAL /
 HERMANN**

S61008SDB

Bianco *White*
 RAL 9016

21,36

1

Con attacco flangia Ø138
With Ø138 fastening flange

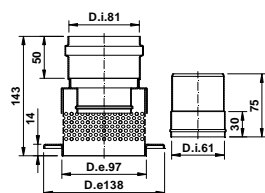

Compatibile *Suitable for:*
**ARISTON
 CHAFFOTEAUX
 ECOFLAM
 RHEEM RADI**

S61008MSFB

Bianco *White*
 RAL 9016

22,35

1

Compatibile *Suitable for:*
**ARGO
 BAXI
 BERETTA
 RIELLO
 SYLBERT**

S61008FSFB

Bianco *White*
 RAL 9016

22,35

1

Compatibile *Suitable for:*
JUNKERS BOSCH

S61008JUB

Bianco *White*
 RAL 9016

22,35

1

Con attacco flangia Ø138
With Ø138 fastening flange

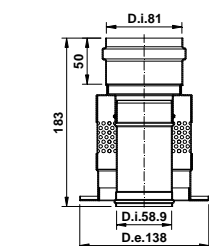
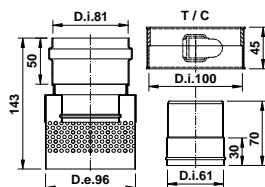
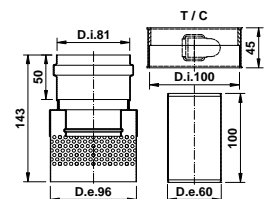

KIT S 2 – Completo di guarnizioni a triplo labbro in Silicone, di guarnizioni per flange e viti di fissaggio, terminale Aria in PA, terminale Fumi in Acciaio Inox, sdoppiatore, tubi in Alluminio Estruso in Lega EN AW-6060, curve in Alluminio Pressofuso in Lega EN AB-46100 Rm40
 With triple lip silicon seal, seals for flange and screws, PA air terminal, Stainless steel flue terminal, connection, Extruded Aluminum pipes Alloy EN AW-6060, Die-casted Alu bends Alloy EN AB-46100 Rm40

Compatibile *Suitable for:*

ARCA – ARGO – BALTUR – BAXI – BERETTA – BIASI – BONGIANNI – EUROTERM – FINTERM – FONDITAL – HERMANN – LAMBORGHINI – PENSOTTI – PROTHERM – RHOSS – RIELLO – RINNAI – ROCA – SANT’ANDREA – SARIGAS – SAVIO – SILE – SIME – SYLBER – UNICAL

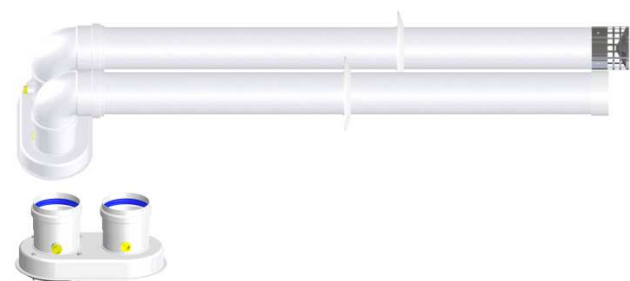
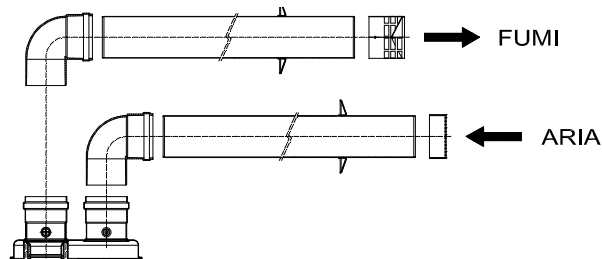

con ispezione fumi/aria *with flue/air inspection*

KITS02B	1000 mm	Bianco <i>White</i> RAL 9016	63,56	1
----------------	---------	---------------------------------	-------	---

KIT S 5 – Completo di guarnizioni a triplo labbro in Silicone, di guarnizioni per flange e viti di fissaggio, terminale Aria in PA, terminale Fumi in Acciaio Inox, raccordo di partenza, tubi in Alluminio Estruso in Lega EN AW-6060, curve in Alluminio Pressofuso in Lega EN AB-46100 Rm40
 With triple lip silicon seal, seals for flange and screws, PA air terminal, Stainless steel flue terminal, starting adapter, Extruded Aluminum pipes Alloy EN AW-6060, Die-casted Alu bends Alloy EN AB-46100 Rm40

Compatibile *Suitable for:*

ARISTON – CHAFFOTEAUX – ECOFLAM – RHEEM RADI - SIMAT

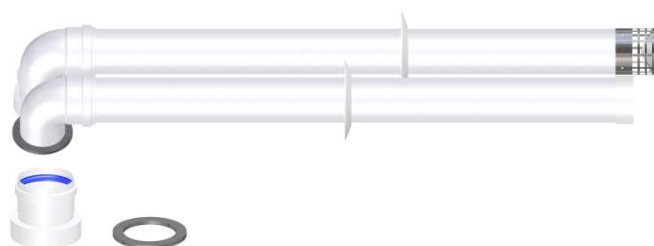
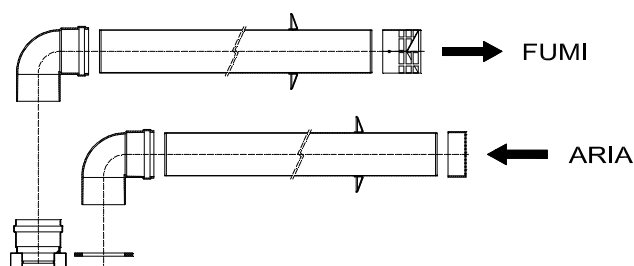

KITS05B	1000 mm	Bianco <i>White</i> RAL 9016	52,10	1
----------------	---------	---------------------------------	-------	---

KIT S 6 – Completo di guarnizioni a triplo labbro in Silicone, di guarnizioni per flange e viti di fissaggio, terminale Aria in PA, terminale Fumi in Acciaio Inox, raccordo di partenza, tubi in Alluminio Estruso in Lega EN AW-6060, curve in Alluminio Pressofuso in Lega EN AB-46100 Rm60

With triple lip silicon seal, seals for flange and screws, PA air terminal, Stainless steel flue terminal, starting adapter, Extruded Aluminum pipes Alloy EN AW-6060, Die-casted Alu bends Alloy EN AB-46100 Rm60

Compatibile *Suitable for:*

IMMERGAS

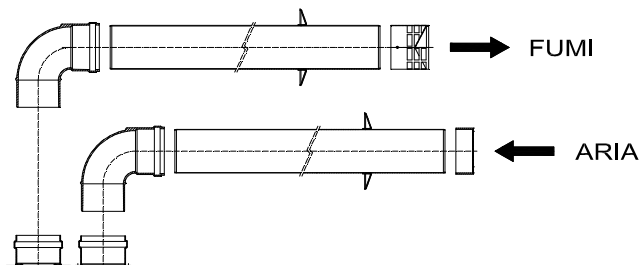

KITS06B	1000 mm	Bianco <i>White</i> RAL 9016	68,25	1
KITS06A *	1000 mm	Avorio Opaco <i>Opaque Ivory</i>	70,98	1

KIT S 9 – Completo di guarnizioni a triplo labbro in Silicone, di guarnizioni per flange e viti di fissaggio, terminale Aria in PA, terminale Fumi in Acciaio Inox, raccordo di partenza, tubi in Alluminio Estruso in Lega EN AW-6060, curve in Alluminio Pressofuso in Lega EN AB-46100 Rm40

With triple lip silicon seal, seals for flange and screws, PA air terminal, Stainless steel flue terminal, starting adapter, Extruded Aluminum pipes Alloy EN AW-6060, Die-casted Alu bends Alloy EN AB-46100 Rm40

Compatibile *Suitable for:*

ARCA – ARGO – BALTUR – BAXI – BERETTA – BIASI – BONGIOANNI – EUROTERM – FINTERM – FONDITAL – HERMANN – LAMBORGHINI – PENSOTTI – PROTHERM – RHOSS – RIELLO – RINNAI – ROCA – SANT’ANDREA – SARIGAS – SAVIO – SILE – SIME – SYLBER – UNICAL

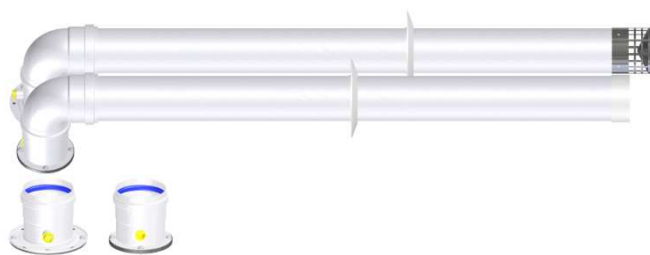
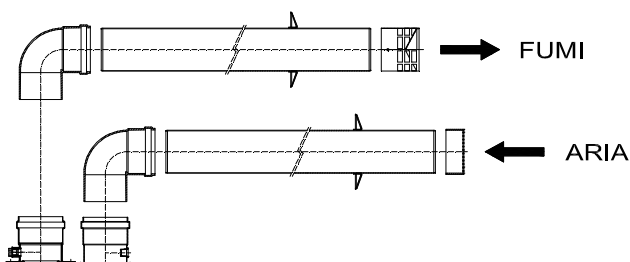

KITS09B	1000 mm	Bianco <i>White</i> RAL 9016	70,52	1
----------------	---------	---------------------------------	-------	---

con ispezione fumi/aria *with flue/air inspection*

sistemi per intubamento EUROBLOCK

facile installazione, perfetta funzionalità tecnica, prodotto a norma UNI-CIG 10845/2000



COMPONENTI SCARICO FUMI PER CALDAIE A GAS

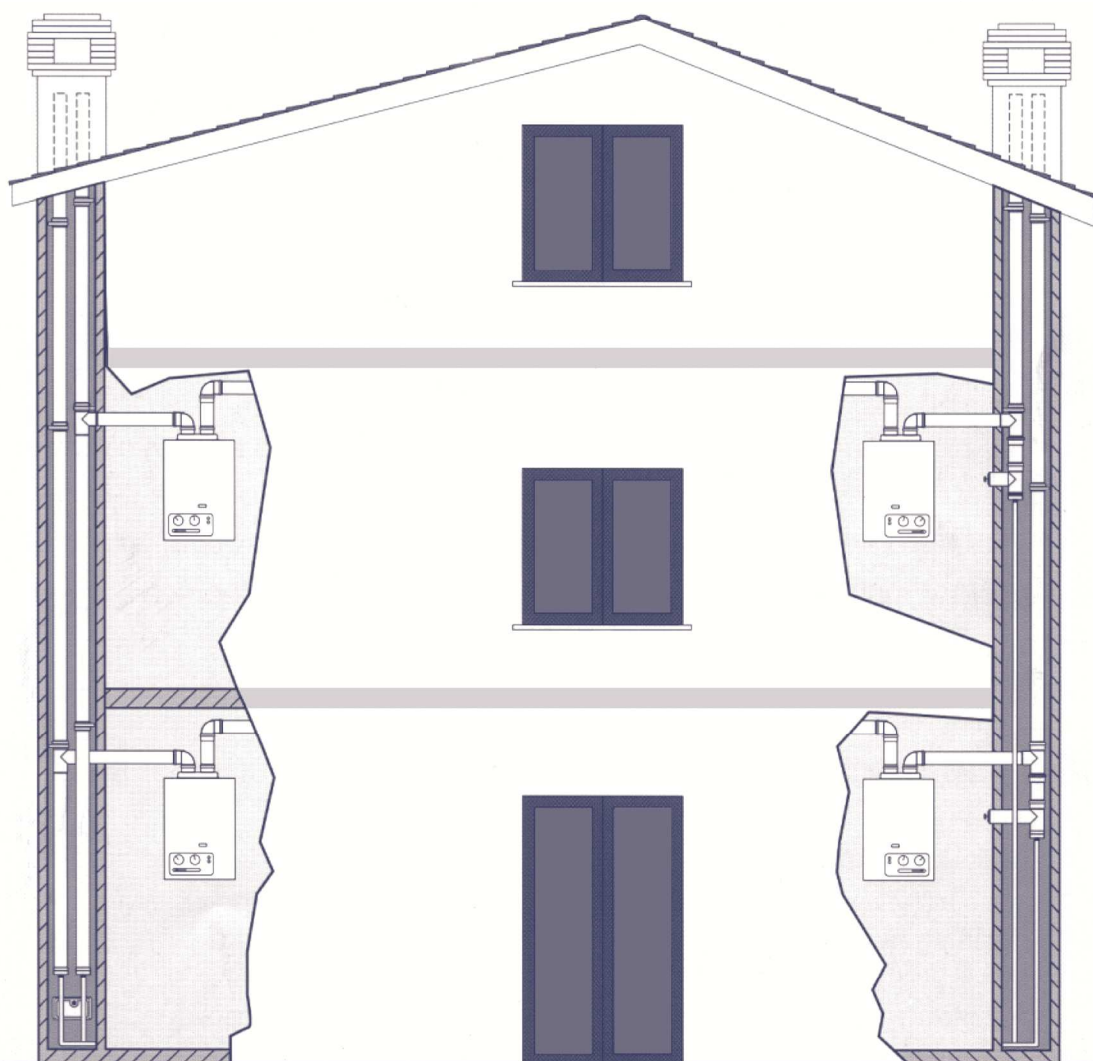

www.contisrl.it

rapporto di prova



**LABORATORIO TECNLOGICO SPERIMENTALE
PER PROVE SU MATERIALI DA COSTRUZIONE**

Autorizzato con D.M. del 18.10.84 n. 25234

s.s. 17 zona industriale - 67039 sulmona (aq) - tel/fax 0864-251475

sede legale: via c.de. fitta, 12 - 65129 pescara - tel/fax 085-4511100

c.f. e p. Iva 01066970680

www.abruzzo-test.it - e-mail: info@abruzzo-test.it

CENTRO "ACCIAI"

Pagina 1 di 1

RAPPORTO DI PROVA: N.AT10079FE/01

Sulmona, li 20.07.01

Accettazione del: 17.07.01 N.10016

Richiedente: Ditta CONTI SRL

Indirizzo: NOCCIANO (PE) - C.da Fonteschiavo

Descrizione materiale: Tubi in alluminio (99% alluminio lega UNI 9006)
diam. 80 - spessore 1,5 mm - maschio-femmina (MF)

Prova richiesta: Prova di disgiunzione - Norma UNI 10845/2000 punto 7.4.1

RISULTATI DELLA PROVA

CAMPIONE 1	kg 230
CAMPIONE 2	kg 330
CAMPIONE 3	kg 340
CAMPIONE 4	kg 280
VALORE MEDIO ALLA DISGIUNZIONE	forza kg 295



IL DIRETTORE DEL LABORATORIO
(Dott. Arch. Francesco Vacri)

prodotto per intubamento

per scarico gas combusti caldaie a camera stagna (classe C)

l'intubamento consiste nell'inserire all'interno di un camino, canna fumaria o vano tecnico preesistente, un condotto apposito atto a scaricare a tetto i gas combusti.

La norma UNI 10845 del febbraio 2000, prescrive le caratteristiche tecniche di detto condotto:

- **DIMENSIONAMENTO:** sono previsti calcoli specifici per i diametri utilizzabili; in un camino esistente è possibile l'intubamento di uno o più condotti $d=80$.

*Esempi di inserimento di più condotti di sezione circolare nello stesso camino secondo le norme UNI 10845:2000

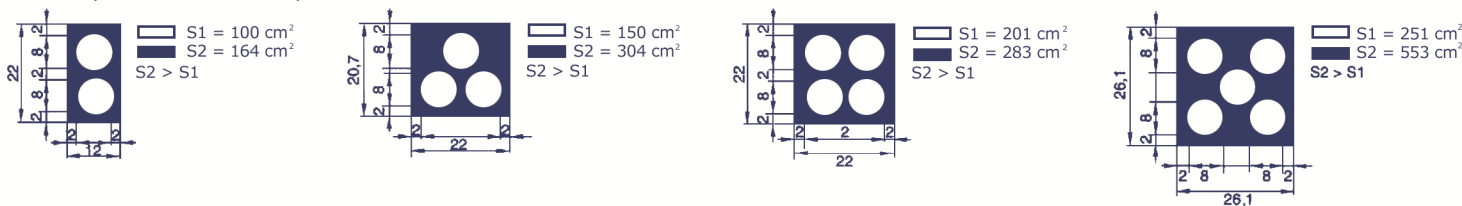

- **TIPOLOGIA DI MATERIALE:** sono elencati materiali e spessori utilizzabili, tra cui: ALLUMINIO 99% - spessore mm. 1.50

- **DISGIUNZIONE e tenuta dei giunti di collegamento:** il condotto è realizzabile con più elementi giuntabili tra di loro, purchè siano garantiti la disgiunzione degli stessi e la tenuta.

linea di condotti per intubamento EUROBLOCK

La CONTI ha realizzato la linea **EUROBLOCK**: una linea di prodotti in alluminio per intubamento.

EUROBLOCK è la soluzione ideale per garantire:

- **Sicurezza:** rispondenza del prodotto alle caratteristiche previste dalla norma UNI 10845
- **Versatilità:** facilità d'installazione del prodotto con alta efficacia tecnica.
- **Competitività:** concorrenzialità del prodotto sul mercato.

CARATTERISTICHE TECNICHE

- **Dimensionamento:** tubi estrusi $d=80$
- **Tipologia di materiale:** ALLUMINIO 99% - Lega UNI 9006 - spessore mm. 1.50
- **Disgiunzione garantita*:** gli elementi sono realizzati con innesto a bicchiere maschio/femmina, con guarnizione di tenuta e con un particolare **sistema di bloccaggio brevettato (antisfilamento)** che garantisce la disgiunzione degli elementi durante l'installazione e durante le normali condizioni d'esercizio.



* La disgiunzione è garantita e comprovata dalle prove effettuate dal laboratorio specializzato ABRUZZO TEST, con rapporto di prova n. AT10079/FE01

TUBO in Alluminio Estruso con bloccaggio brevettato in Lega *Extruded Aluminum PIPE with patented locking Alloy* **EN AW-6060**

Completo di guarnizione a triplo labbro in Silicone *With triple lip silicon seal*

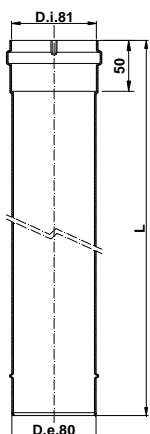

M/F 15/10

Bicchieratura Calibrata
 Calibrated Female Side Diameter

CODICE CODE	LUNGHEZZA LENGTH	COLORE COLOUR	€/Pz €/Pcs	Pz/Conf. Pcs/Box
TAINT28MFN	2000 mm		30,68	10
TAINT81MFN	1000 mm	Alluminio Naturale Natural Aluminum	15,74	10
TAINT85MFN	500 mm		9,56	9

TEE in Alluminio Pressofuso con bloccaggio in Lega *Die-casted Aluminum TEE with locking Alloy* **EN AB-46100**

Completo di guarnizione a triplo labbro in Silicone *With triple lip silicon seal*

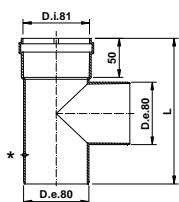

M/M/F 20/10

N.B. In caso di applicazione del tappo scarico condensa togliere la vite *
 Remove the screw in case you use the condensing drain plug *

CODICE CODE	LUNGHEZZA LENGTH	COLORE COLOUR	€/Pz €/Pcs	Pz/Conf. Pcs/Box
TEINTMM8N	186 mm	Alluminio Naturale Natural Aluminum	15,62	6
TISSC08N		Alluminio Naturale Natural Aluminum	8,70	6

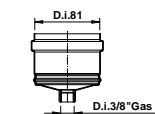

Tappo scarico condensa in Alluminio
 Aluminum condensation drain plug 15/10

Bicchieratura Calibrata
 Calibrated Female Side Diameter

Il sistema offre diverse modalità d'impiego e facilità d'installazione:

- (1) Accostare i due tubi innestando le bulinature di bloccaggio* (B) del tubo maschio nei canali guida (A) del tubo femmina.
- (2) Ruotare i tubi in senso opposto (non oltre 176°)
 Per eventuale sbloccaggio far coincidere la bulinatura di riscontro (C) con il canale guida (A).

* modello di brevetto depositato

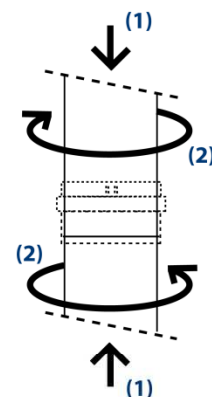

Intubamento con ispezione

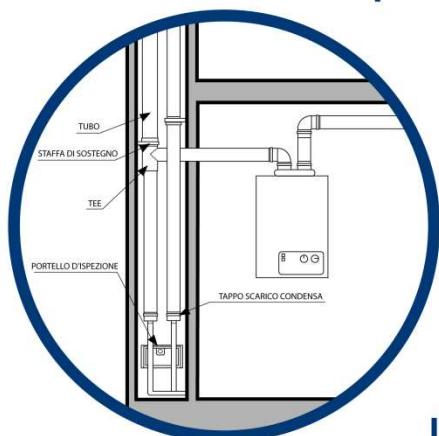

Intubamento con ispezione laterale

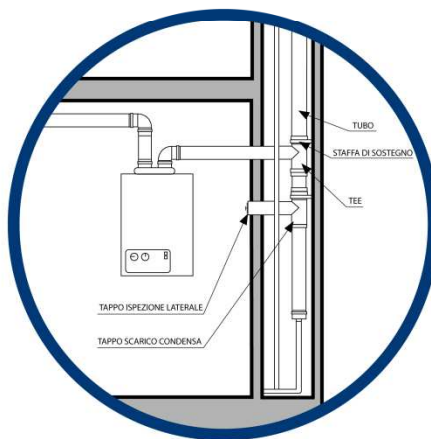

A - canale d'ingresso e di guida
 B - Bulinatura di bloccaggio
 C - Bulinatura di riscontro (per eventuale estrazione)

TUBO in Alluminio Estruso in Lega *Extruded Aluminum PIPE Alloy* EN AW-6060

Completo di guarnizione a triplo labbro in Silicone *With triple lip silicon seal*

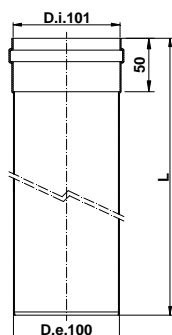

M/F 10/10

M/F 10/10

TA120MFB
TA101MFB
TA105MFB
TA102MFB

2000 mm
 1000 mm
 500 mm
 250 mm

Bianco *White*
 RAL 9016

32,04
 17,19
 11,98
 5,98

7
 7
 6
 1

TA120MFN
TA101MFN
TA105MFN
TA102MFN

2000 mm
 1000 mm
 500 mm
 250 mm

Alluminio Naturale
Natural Aluminum

29,95
 15,94
 11,04
 5,34

7
 7
 6
 1

Bicchieratura Calibrata
Calibrated Female Side Diameter

TUBO in Alluminio Estruso con portello ispezione orizzontale/verticale in Lega

Extruded Aluminum PIPE with horizontal/vertical inspection door Alloy EN AW-6060

Completo di guarnizione a triplo labbro in Silicone e viti *With triple lip silicon seal and screws*

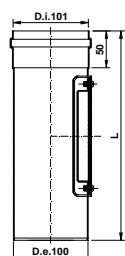

M/F 10/10

TCSI100B

285 mm

Bianco *White*
 RAL 9016

15,17

1

TCSI100N

285 mm

Alluminio Naturale
Natural Aluminum

14,40

1

Bicchieratura Calibrata
Calibrated Female Side Diameter

CURVA 90° in Alluminio Pressofuso in Lega *90° Die-casted Aluminum BEND Alloy* EN AB-46100

Completo di guarnizione a triplo labbro in Silicone *With triple lip silicon seal*

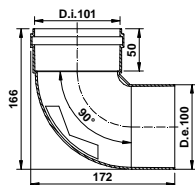

M/F 20/10
 R 60 mm

CAP9010B

Bianco *White*
 RAL 9016

14,43

8

CAP9010N

Alluminio Naturale
Natural Aluminum

13,85

8

CURVA 45° in Alluminio Pressofuso in Lega *45° Die-casted Aluminum BEND Alloy* EN AB-46100

Completo di guarnizione a triplo labbro in Silicone *With triple lip silicon seal*

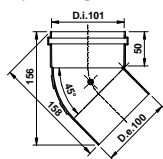

M/F 20/10
 R 50 mm

CAP4510B

Bianco *White*
 RAL 9016

11,80

6

TEE in Acciaio *Steel TEE*

Completo di guarnizione a triplo labbro in Silicone *With triple lip silicon seal*

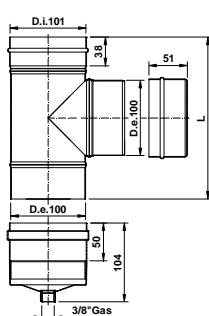

M/M/F

M/M/F
 Completo di tappo
 ispezione
 with inspection plug

M/M/F
 Completo di tappo scarico
 condensa
 with condensing drain plug

TEIMM10V

213 mm

Bianco *White*
 RAL 9016

26,80

1

TEIMM10N

213 mm

Acciaio *Steel*

25,10

1

TEIS10V

213 mm

Bianco *White*
 RAL 9016

34,50

1

TEIS10N

213 mm

Acciaio *Steel*

33,50

1

TEISCM10V

280 mm

Bianco *White*
 RAL 9016

36,80

1

TEISCM10N

280 mm

Acciaio *Steel*

35,60

1

MANICOTTO in EPDM con fascetta metallica *EPDM SLEEVE with metal clamp*

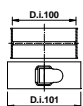

FMPV10B

Bianco *White*
 RAL 9016

5,15

12

TUBO in Alluminio Estruso in Lega *Extruded Aluminum PIPE Alloy* **EN AW-6060**

Completo di guarnizione a triplo labbro in Silicone *With triple lip silicon seal*

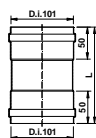

M/F 10/10

MFF1010B

150 mm

Bianco *White*
 RAL 9016

9,94

4

MFF1010N

150 mm

Alluminio Naturale
Natural Aluminum

9,58

4

Bicchieratura Calibrata
Calibrated Female Side Diameter

TUBO di Centraggio Inox *Steel Centering PIPE*

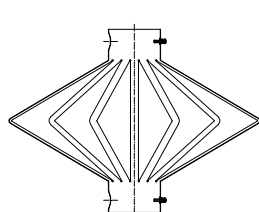

TUBCENTR100

500 mm

Acciaio Inox
Stainless steel
 AISI 304

27,00

1

TERMINALE scarico fumi in Acciaio Inox *Stainless Steel flue outlet TERMINAL*

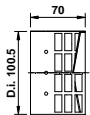

Orizzontale
Horizontal

TERM10I

Acciaio Inox
Stainless steel
 AISI 304

6,06

8

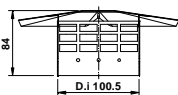

Verticale
Vertical

TERM10IA

Acciaio Inox
Stainless steel
 AISI 304

12,59

6

COLLARE in Acciaio *Steel WALL BRACKET*

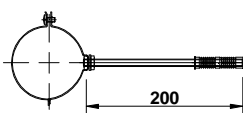

Lunghezza gambo
Anchor length
 200 mm

COFERB10

Bianco *White*
 RAL 9016

3,78

25

COFER10N

Naturale
Natural

3,05

10

ROSONE coprimuro in EPDM *EPDM wall Cover*

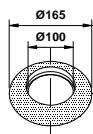

RCEP10

Bianco
White

2,52

15

GUARNIZIONE in SILICONE *SILICON SEAL*

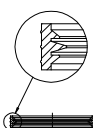

A triplo labbro
Triple lip

ORL10S

Azzurro
Blue

1,72

10